

File\\Name:c:\\users\\381p\\desktop\\local projects\\grise fiord\\22-4671_ip.dwg

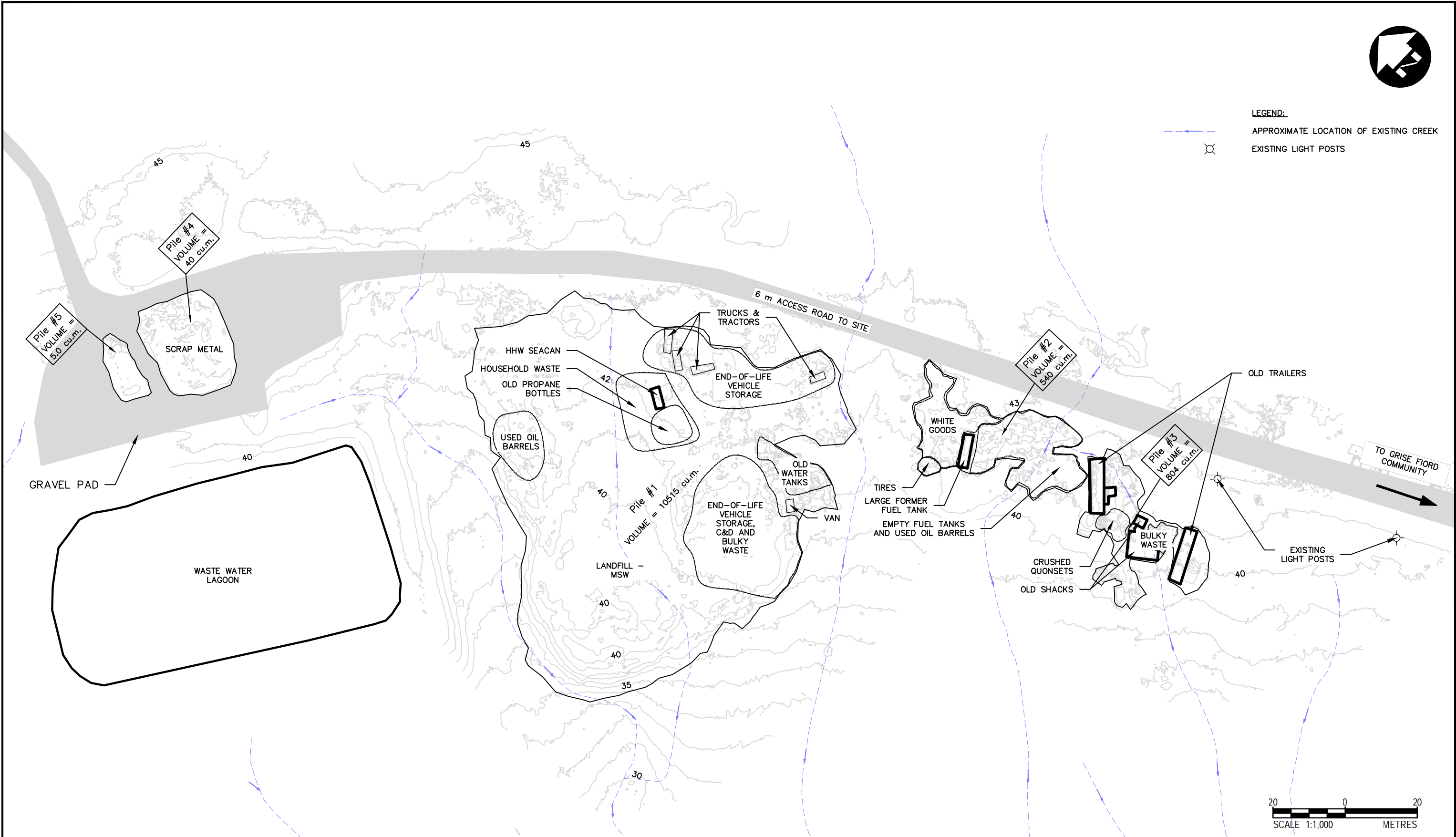

NOTES: 1. ACCEPTED MATERIALS INCLUDE TIRES, E-WASTE, HOUSEHOLD HAZARDOUS WASTE, METALS, WHITE GOODS, TANKS, VEHICLES, WOOD, AND MSW.	 DILLON CONSULTING	PROJECT	BUSINESS CASE - SOLID WASTE FACILITY UPGRADES, GRISE FIORD, NU	PROJECT NO.	22-4671
		TITLE	EXISTING CONDITIONS	FIGURE NO.	1

File\\Name c:\\users\\38\\p\\desktop\\local projects\\grise fiord\\22-4671_ip.dwg

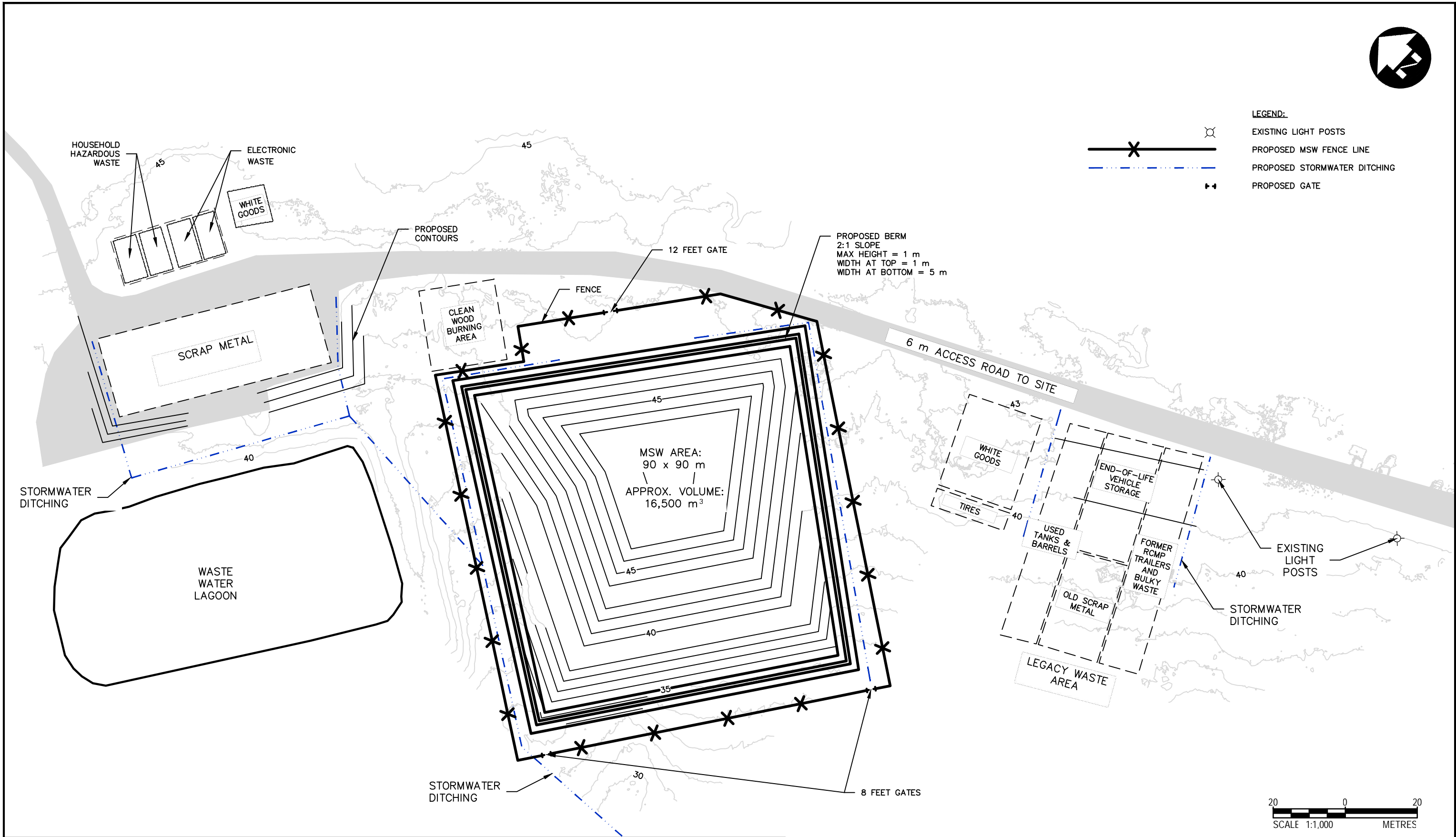

NOTES: 1. ACCEPTED MATERIALS INCLUDE TIRES, E-WASTE, HOUSEHOLD HAZARDOUS WASTE, METALS, WHITE GOODS, TANKS, VEHICLES, WOOD, AND MSW.	 DATE MAY 2024	PROJECT BUSINESS CASE - SOLID WASTE FACILITY UPGRADES, GRISE FIORD, NU	PROJECT NO. 22-4671
		TITLE SCHEMATIC DESIGN - MANDATORY COMPONENTS	FIGURE NO. 2